

SECTOR-12

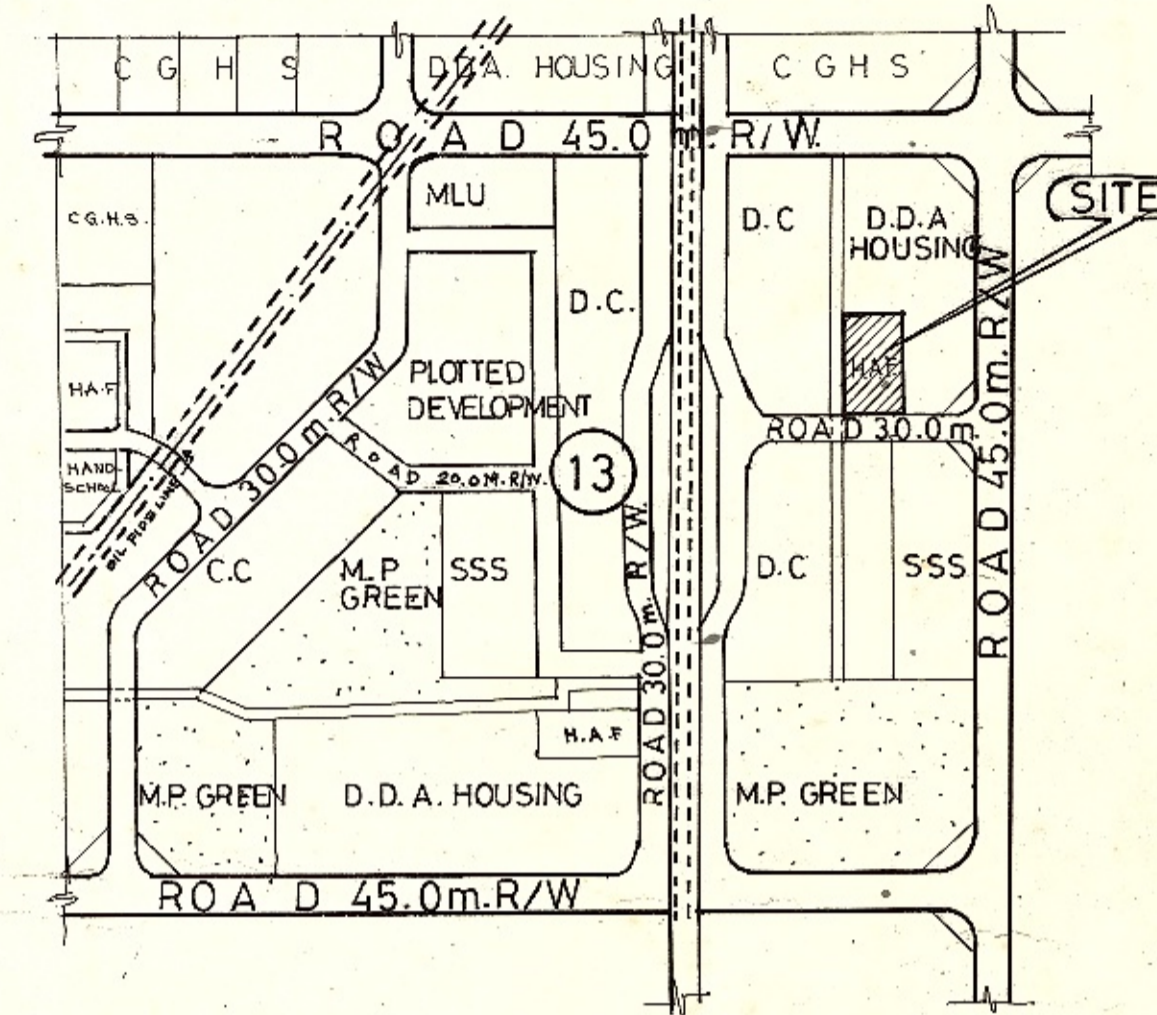
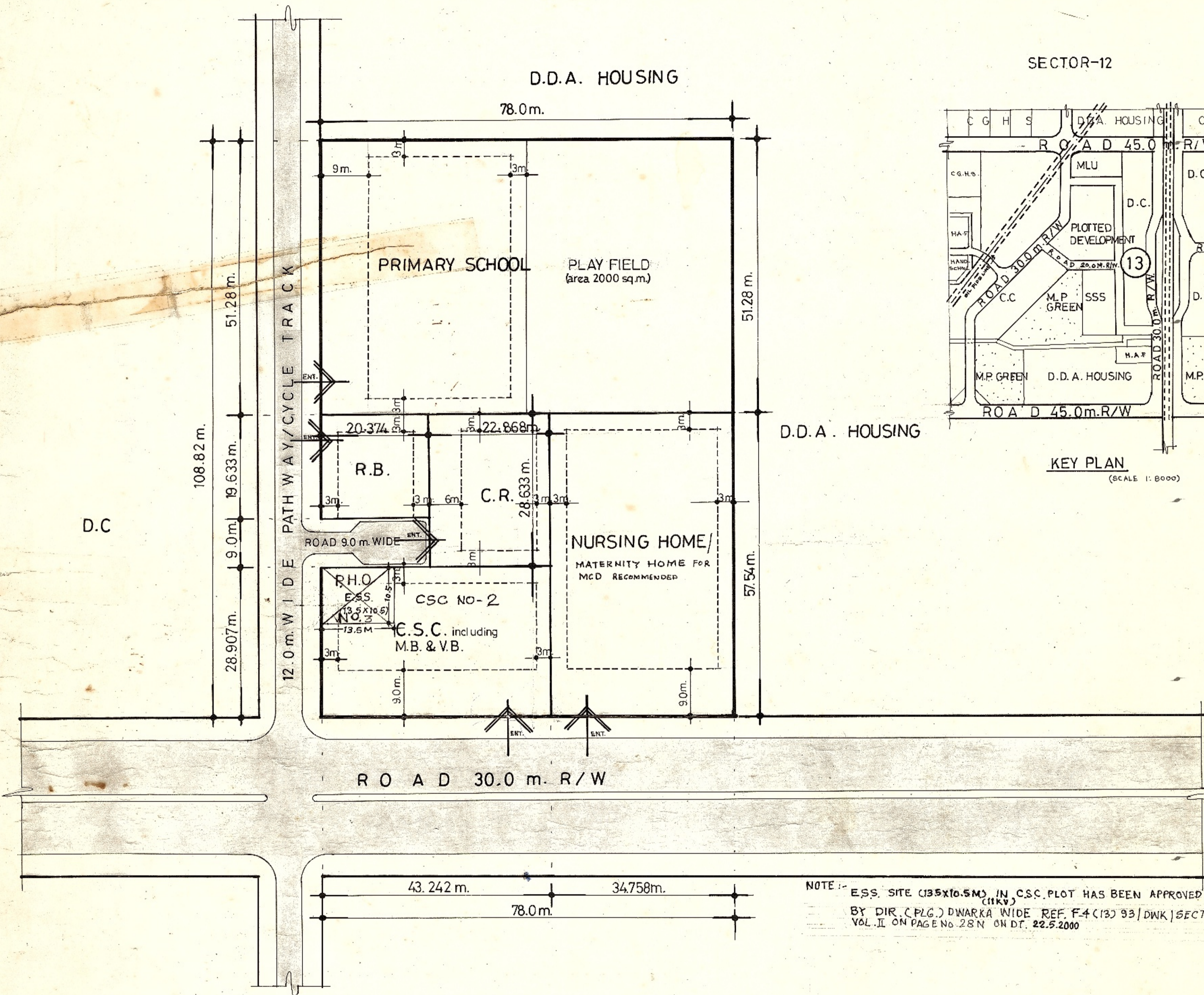

KEY PLAN
(SCALE 1:8000)

AREA STATEMENT..
TOTAL AREA OF THE PLOT.. 8487.96 sq. m.

FACILITY	AREA	GR. COV.	F.A.R.	MAX.HT.
1. PRIMARY SCHOOL	3999.84 sq.m.	33%	100	14mts.
2. NURSING HOME	1999.975 sq.m.	33%	100	14 mts.
3. CONVENIENT SHOPPING CENTRE	1250.00 sq.m.	40%	60	8 mts.
4. COMUNITY CENTRE	654.779 sq.m.	33.33%	66.66%	8 mts.
5. RELIGIOUS BUILDING	400.00 sq.m.	33.33%	66.66%	8 mts.
6. CIRCULATION	183.366 sq.m.	-	-	-

- NOTES...
1. THE PLAN IS SUBJECT TO MODIFICATIONS WITHIN THE FRAME WORK OF MASTER PLAN/ ZONAL PLAN.
 2. IT IS FOR PLANNING PURPOSE & IS NOT FIT TO BE PRODUCED IN THE COURT OF LAW FOR PROPERTY DISPUTES.
 3. ALL THE DIMENSIONS & AREA GIVEN IN THE PLAN ARE SUBJECT TO CONFIRMATION OF OWNERSHIP/ ALLOTMENT STATUS AND DEMARICATIONS/ FEASIBILITY REPORT FROM THE DDA LANDS & ENGINEERING WING RESPECTIVELY.

- NOTES...
1. DO NOT SCALE THE DRAWING FOLLOW ONLY THE WRITTEN DIMENSION.
 2. ALL THE DIMENSIONS SHALL BE CHECK BEFORE EXECUTION.
 3. INTERSECTION TO BE DESIGN LATER.

APPROVED BY V.C., D.D.A. DT 9/9/96 AT PAGE 81N IN FILE NO. - F 8 (10) 94/DWK/HAFB/PART I

NURSING HOME/ MATERNITY HOME PROPOSED FOR ALLOTMENT TO M.C.D. VIDE LETTER NO. F-1(365/96/DWK) 225 DATED 20.3.97 IN FILE NO. F-1(315)96/DWK.

HOUSING AREA FACILITY PKT-2

IDWARKA SUB-CITY (PAPANIKALAD)

10 5 0 10 20 SCALE 1:500		SECTOR-13 PH-II
(S.P.VERMA) PLG. D/MAN	PLG. ASST.	DRG. NO. DWK/SEC13/HAF7 SEP196/0022 DATE 17.4.95
(T.SINGH) ASST. DIRECTOR	(ANIL BARAI) JOINT DIRECTOR	(S.SRIVASTAVA) PROJECT DIRECTOR
DELHI DEVELOPMENT AUTHORITY		

NOTE:- E.S.S. SITE (135x10.5M) IN C.S.C. PLOT HAS BEEN APPROVED BY DIR. (PLG.) DWARKA WIDE REF. F-4 (13) 93/DWK/SECT.13 VOL. II ON PAGE No. 28N ON DT. 22.5.2000